

Specification

| | | |
|----------------------------------|---------------------------------------------------------------------------------------------------------------------|-------------------------------|
| Nominal Voltage | 2V | |
| Nominal Capacity(10hrs rate) | 300.0AH | |
| Dimension | Length | 170 ± 2mm(6.69 inches) |
| | Width | 150 ± 2mm(5.90 inches) |
| | Container Height | 328 ± 2mm(12.91 inches) |
| | Total Height (with Terminal) | 350 ± 2mm(13.78 inches) |
| Approx Weight | Approx 20.2Kg (44.5lbs) | |
| Design Float Life | 20 years at 25°C(77°F) | |
| Container Material | ABS | |
| Rated Capacity | 322.0AH/16.1A | (20hr, 1.80V/cell, 25°C/77°F) |
| | 300.0AH/30.0A | (10hr, 1.80V/cell, 25°C/77°F) |
| | 261.0AH/52.2A | (5hr, 1.75V/cell, 25°C/77°F) |
| | 234.0AH/78.0A | (3hr, 1.75V/cell, 25°C/77°F) |
| | 186.0AH/186.0A | (1hr, 1.60V/cell, 25°C/77°F) |
| Max. Discharge Current | 2400A (5s) | |
| Internal Resistance | Approx 0.9mΩ | |
| Operating Temp. Range | Discharge : | -15~50°C (5~120°F) |
| | Charge : | 0~40°C (5~104°F) |
| | Storage : | -15~40°C (5~104°F) |
| Nominal Operating Temp. Range | 25 ± 3°C (77 ± 5°F) | |
| Cycle Use | Initial Charging Current less than 90.0A. Voltage 2.4V~2.5V at 25°C(77°F)Temp. Coefficient -5mV/°C | |
| | Standby Use No limit on Initial Charging Current Voltage 2.25V~2.3V at 25°C(77°F)Temp. Coefficient -3mV/°C | |
| Capacity affected by Temperature | 40°C (104°F) | 103% |
| | 25°C (77°F) | 100% |
| | 0°C (32°F) | 86% |
| Self Discharge | ≤1.5% per month | |
| | RUZET TPG series batteries may be stored for up to 6 months at 25°C(77°F) and then a freshening charge is required. | |

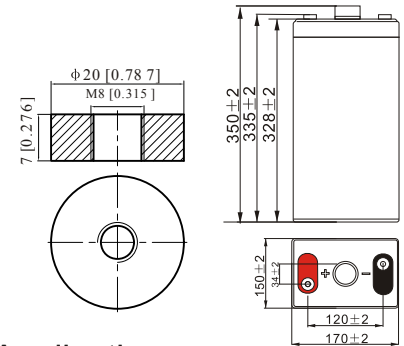

Applications

- UPS and EPS
- Emergency light
- Railway signal and aircraft signal system
- Marine and power stations Alarm and security system
- Electronic apparatus and equipment
- Communication power supply, DC power supply

Constant Current Discharge (Amperes) at 25°C (77°F)

| F.V/Time | 10 min | 15 min | 20 min | 30 min | 45 min | 1h | 2h | 3h | 4h | 5h | 6h | 8h | 10h | 20h |
|------------|--------|--------|--------|--------|--------|-------|-------|------|------|------|------|------|------|------|
| 1.85V/cell | 351.0 | 295.2 | 261.9 | 217.2 | 167.6 | 143.4 | 92.9 | 69.8 | 57.2 | 48.1 | 42.2 | 33.8 | 29.1 | 15.5 |
| 1.80V/cell | 401.6 | 331.5 | 289.6 | 235.9 | 180.8 | 151.4 | 99.8 | 75.0 | 60.8 | 51.0 | 44.7 | 35.6 | 30.0 | 16.1 |
| 1.75V/cell | 456.2 | 373.6 | 320.0 | 256.4 | 197.2 | 165.0 | 103.8 | 78.0 | 62.9 | 52.2 | 46.1 | 36.8 | 30.8 | 16.5 |
| 1.70V/cell | \ | 414.5 | 353.2 | 279.9 | 212.4 | 174.6 | 109.4 | 82.1 | 65.7 | 55.2 | 48.3 | 38.3 | 32.0 | 16.9 |
| 1.65V/cell | \ | 443.8 | 375.8 | 295.4 | 224.8 | 180.6 | 113.4 | 85.4 | 68.3 | 56.9 | 50.0 | 39.6 | 32.9 | 17.4 |
| 1.60V/cell | \ | 486.1 | 408.2 | 315.2 | 233.6 | 186.0 | 116.3 | 87.6 | 69.8 | 58.3 | 51.0 | 40.3 | 33.6 | 17.7 |

Constant Power Discharge (Watts) at 25°C (77°F)

| F.V/Time | 10 min | 15 min | 20 min | 30 min | 45 min | 1h | 2h | 3h | 4h | 5h | 6h | 8h | 10h | 20h |
|------------|--------|--------|--------|--------|--------|--------|--------|--------|--------|--------|-------|-------|-------|-------|
| 1.85V/cell | 624.19 | 530.19 | 475.14 | 398.38 | 310.00 | 266.19 | 173.52 | 130.95 | 107.62 | 90.76 | 79.71 | 64.29 | 55.33 | 29.52 |
| 1.80V/cell | 705.90 | 587.52 | 517.71 | 426.19 | 331.81 | 279.43 | 185.24 | 139.90 | 113.71 | 95.71 | 84.10 | 67.43 | 57.05 | 30.57 |
| 1.75V/cell | 789.05 | 654.10 | 566.67 | 459.33 | 358.57 | 303.24 | 192.00 | 144.86 | 117.24 | 97.71 | 86.48 | 69.52 | 58.48 | 31.24 |
| 1.70V/cell | \ | 715.71 | 620.86 | 498.76 | 384.76 | 319.90 | 201.81 | 152.19 | 122.29 | 103.14 | 90.48 | 72.38 | 60.67 | 32.10 |
| 1.65V/cell | \ | 760.48 | 655.62 | 522.00 | 403.52 | 328.48 | 208.00 | 157.71 | 126.67 | 106.00 | 93.43 | 74.57 | 62.29 | 33.05 |
| 1.60V/cell | \ | 819.33 | 704.57 | 553.14 | 417.14 | 336.57 | 212.29 | 161.05 | 129.05 | 108.19 | 95.05 | 75.71 | 63.52 | 33.52 |