

### Specification

Nominal Voltage	12V	
Nominal Capacity(10hrs rate)	45.0AH	
Dimension	Length	197 ± 2mm(7.76 inches)
	Width	165 ± 2mm(6.50 inches)
	Container Height	170 ± 2mm(6.69 inches)
	Total Height (with Terminal)	170 ± 2mm(6.69 inches)
Approx Weight	Approx 14.5 Kg (32.0 lbs)	
Design Float Life	12 years at 25°C(77°F)	
Container Material	ABS	
Rated Capacity	48.1AH/2.41A	(20hr, 1.80V/cell, 25°C/77°F)
	45.0AH/45.0A	(10hr, 1.80V/cell, 25°C/77°F)
	39.1AH/7.83A	( 5hr, 1.75V/cell, 25°C/77°F)
	35.1AH/11.7A	( 3hr, 1.75V/cell, 25°C/77°F)
	27.9AH/27.9A	( 1hr, 1.60V/cell, 25°C/77°F)
Max. Discharge Current	540A (5s)	
Internal Resistance	Approx 7.4mΩ	
Operating Temp. Range	Discharge :	-15~50°C (5~120°F)
	Charge :	0~40°C (5~104°F)
	Storage :	-15~40°C (5~104°F)
Nominal Operating Temp. Range	25 ± 3°C (77 ± 5°F)	
Cycle Use	Initial Charging Current less than 22.5A. Voltage	
	14.4V~15.0V at 25°C(77°F)Temp. Coefficient -30mV/°C	
Standby Use	No limit on Initial Charging Current Voltage	
	13.5V~13.8V at 25°C(77°F)Temp. Coefficient -20mV/°C	
Capacity affected by Temperature	40°C (104°F)	103%
	25°C ( 77°F)	100%
	0°C ( 32°F)	86%
Self Discharge	≤1.5% per month	
	RUZET LPG series batteries may be stored for up to 6 months at 25°C(77°F) and then a freshening charge is required.	

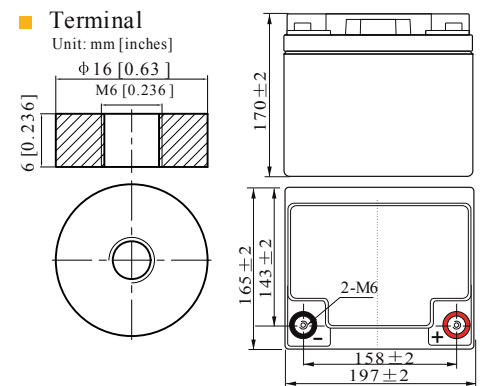

### Applications

- UPS and EPS
- Emergency light
- Railway signal and aircraft signal system
- Marine and power stations Alarm and security system
- Electronic apparatus and equipment
- Communication power supply, DC power supply

### Constant Current Discharge (Amperes) at 25°C (77°F)

F.V/Time	10 min	15 min	20 min	30 min	45 min	1h	2h	3h	4h	5h	6h	8h	10h	20h
1.85V/cell	52.7	44.3	39.3	32.6	25.1	21.5	13.9	10.5	8.58	7.22	6.32	5.07	4.36	2.33
1.80V/cell	60.2	49.7	43.4	35.4	27.1	22.7	15.0	11.3	9.12	7.65	6.70	5.34	4.50	2.41
1.75V/cell	68.4	56.0	48.0	38.5	29.6	24.8	15.6	11.7	9.43	7.83	6.91	5.52	4.62	2.47
1.70V/cell	77.3	62.2	53.0	42.0	31.9	26.2	16.4	12.3	9.86	8.28	7.24	5.75	4.80	2.53
1.65V/cell	83.0	66.6	56.4	44.3	33.7	27.1	17.0	12.8	10.2	8.54	7.49	5.94	4.93	2.61
1.60V/cell	91.3	72.9	61.2	47.3	35.0	27.9	17.4	13.1	10.5	8.75	7.65	6.05	5.04	2.65

### Constant Power Discharge (Watts) at 25°C (77°F)

F.V/Time	10 min	15 min	20 min	30 min	45 min	1h	2h	3h	4h	5h	6h	8h	10h	20
1.85V/cell	93.6	79.5	71.2	59.7	46.5	39.9	26.0	19.6	16.1	13.6	12.0	9.60	8.30	4.44
1.80V/cell	105.9	88.1	77.6	63.9	49.8	41.9	27.8	21.0	17.1	14.4	12.7	10.1	8.55	4.58
1.75V/cell	118.4	98.1	85.1	68.9	53.8	45.5	28.8	21.7	17.6	14.7	13.0	10.4	8.77	4.70
1.70V/cell	130.7	107.3	93.1	74.8	57.1	48.0	30.3	22.9	18.4	15.4	13.6	10.9	9.10	4.81
1.65V/cell	139.1	114.1	98.4	78.3	60.6	49.2	31.2	23.6	19.0	15.9	14.0	11.2	9.34	4.95
1.60V/cell	149.5	122.9	105.7	83.0	62.6	50.5	31.8	24.2	19.3	16.2	14.3	11.3	9.52	5.03